

# KIT PRODUCT TECHNICAL DATASHEET

## SET BR21/354

Brushless 

Intensive use 

Digital Encoder 



### Composition SET BR21/354

CODE	DESCRIPTION	QTY
<b>BR21/351</b>	Electromechanical underground motor BRUSHLESS low voltage, super intensive use, with native encoder on-board, irreversible, ideal for swing gates with leaf up to 4.5 m. Standard version with short 2 m cable.	2
<b>FU101</b>	Foundation box and lid in hot-galvanised steel.	2
<b>RL650</b>	Release system for underground motor with standard lever.	2
<b>KIT EDGE1/20</b>	Electronic kit with digital controller 36V EDGE1/BOX for 2 motors BRUSHLESS.	1
	<b>Composition KIT EDGE1/20</b>	
	<b>EDGE1/BOX</b> Digital control 36V for 2 BRUSHLESS motor, in plastic box.	1
	<b>H93/RX22A/I</b> Plug-in receiver fixe code 2 channels 433,92 MHz (500 storable codes) for control units series H70, B70, EDGE, CTRL and F70.	1
	<b>SYNUS/2</b> Dual code transmitter (modality fixed code or rolling code), 433,92 MHz, 2 channels, with copy function.	2
	<b>R90/F4ES</b> Pair of external photocells synchronized 24V AC/DC, up to a maximum of 4 pairs of photocells.	1
	<b>FIFTHY/24</b> LED flashing light 24V with integrated antenna.	1
	<b>R99/C/001</b> Signboard "Automatic Opening".	1

### PRODUCT TECHNICAL SPECIFICATIONS

Power line supply	230V AC - 50 Hz
Motor power supply	36V
Power rating	200W
Frequency of use	Intensive use
Torque	50 - 300N m
Operating temperature	-20+55°C

Protection level	IP67
Reductor Type	Irreversible
Manoeuvre speed	1,2 Rpm
Opening time	19-29 s
Limit switch	Mechanical stoppers
Recommended digital controllers	-
Encoder	Digital native encoder SENSORLESS 48 PPR
Maximum opening	105° (optional 125° - 360°)
Power supply cable length	2m
Bearing on main shaft	Standard
Operating cycles per day (opening/closing - 24 hours no stop)	1300
Maximum dimension product in mm (L x W x H)	345 x 224 x 144
Product weight packed (Kg)	70,6

# PRODUCT DIMENSIONS AND PREPARING FOR INSTALLATION

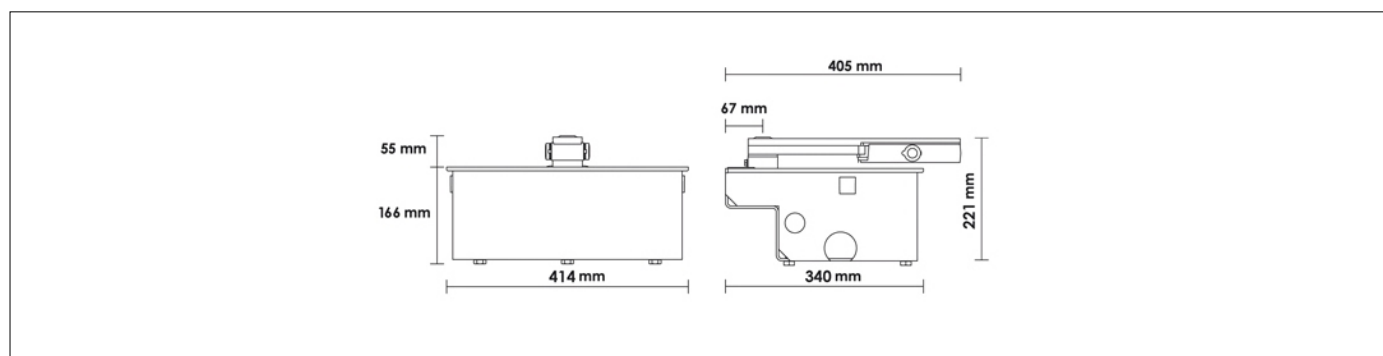

DIMENSIONS

## PRODUCT PREPARING FOR INSTALLATION

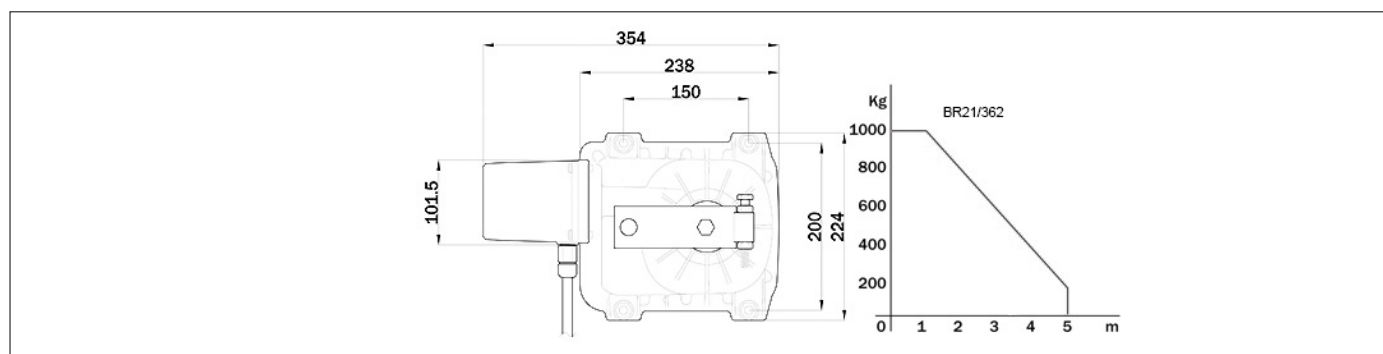

PREDISPOSITION FOR STANDARD INSTALLATION

## PRODUCT ACCESSORIES

<p><b>LT300</b> Levers group for opening up to 125°.</p>	<p><b>LT301</b> Levers group for opening up to 360°.</p>	<p><b>LT301/R</b> Levers group for opening up to 360°, with reinforced chain.</p>	<p><b>LT300/90SX</b> Levers group for opening up to 103° - 90° turned - left.</p>	<p><b>LT300/90DX</b> Levers group for opening up to 103° - 90° turned - right.</p>	<p><b>LT327/SC</b> Pinion gear ¾ Z13 of adaptation in pinion combining ¾ Z16.</p>
<p><b>RL650/R</b> Release system for underground motor with standard lever, reinforced steel version.</p>	<p><b>RL651</b> Release system for underground motor with european cylinder key (DIN).</p>	<p><b>RL663</b> Long release lever for underground motor.</p>			